

CITY OF  
PLEASANT PLAINS

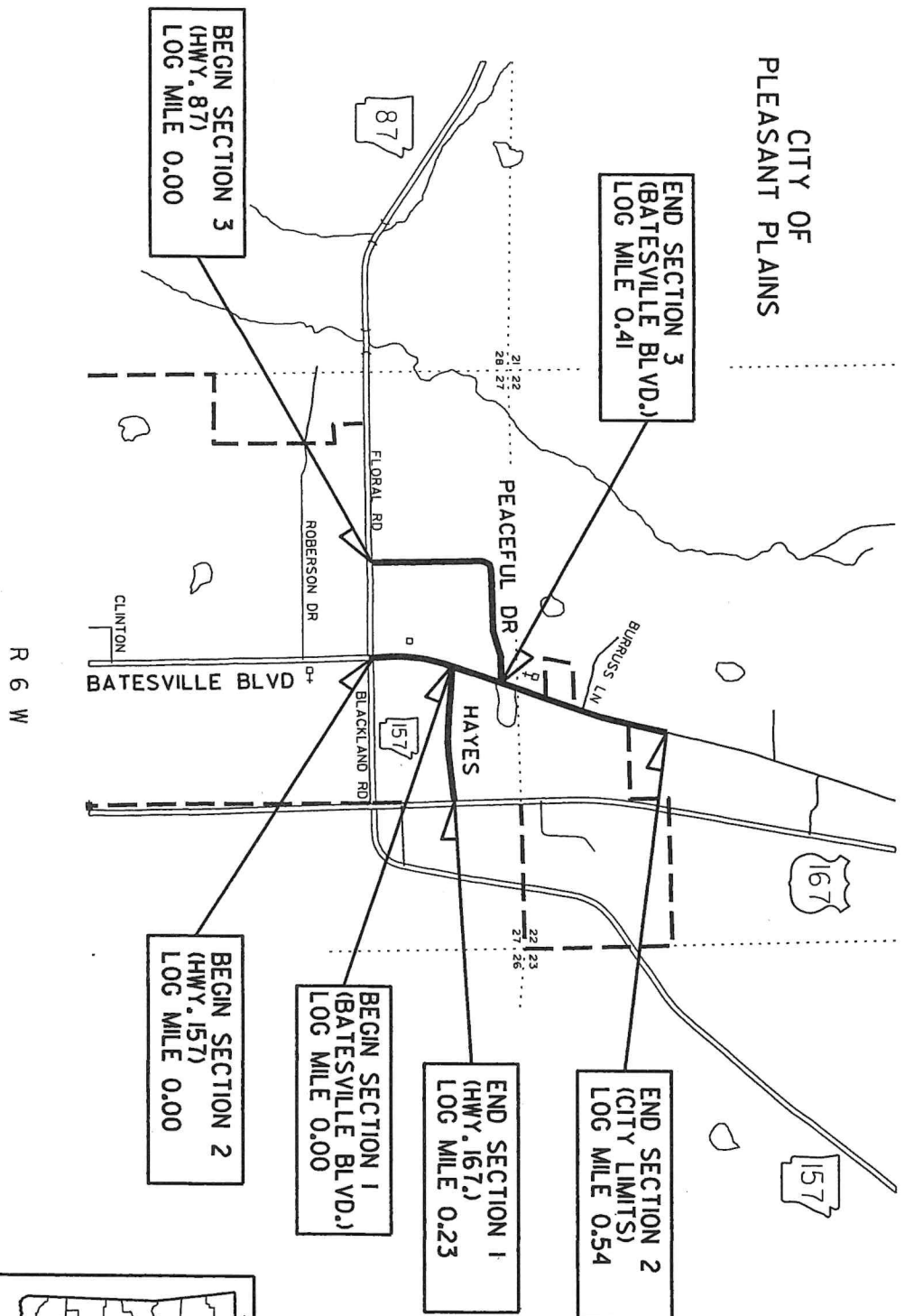

END SECTION 3  
(BATESVILLE BLVD.)  
LOG MILE 0.41

BEGIN SECTION 3  
(HWY. 87)  
LOG MILE 0.00

END SECTION 2  
(CITY LIMITS)  
LOG MILE 0.54

END SECTION 1  
(HWY. 167.)  
LOG MILE 0.23

BEGIN SECTION 1  
(BATESVILLE BLVD.)  
LOG MILE 0.00

BEGIN SECTION 2  
(HWY. 157)  
LOG MILE 0.00



ARK. HWY. DIST. NO. 5

JOB C32004  
PLEASANT PLAINS & SOUTHSIDE OVERLAY (SEL. SECS.) (S)  
VARIOUS CITY STREETS  
INDEPENDENCE COUNTY



MID PROJECT:  
N35° 33' 35"  
W91° 37' 27"

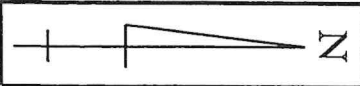

T  
||  
N

END SECTION 6  
(CITY LIMITS)  
LOG MILE 0.80

END SECTION 5 &  
BEGIN SECTION 6  
(4TH STREET)  
LOG MILE 0.06

BEGIN SECTION 5  
(HWY. 157)  
LOG MILE 0.00

END SECTION 4  
(HWY. 167)  
LOG MILE 0.25

BEGIN SECTION 4  
(HWY. 157)  
LOG MILE 0.00

R 6 W

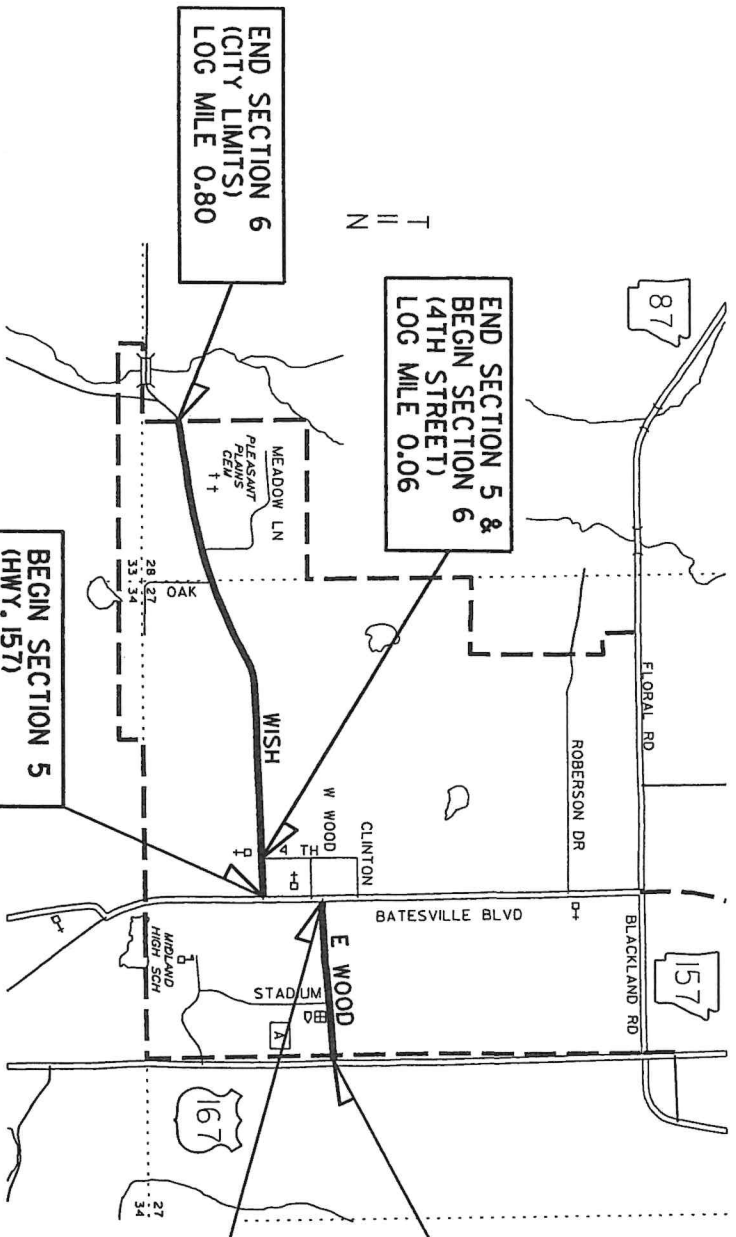

CITY OF  
PLEASANT PLAINS



ARK. HWY. DIST. NO. 5

JOB C32004  
PLEASANT PLAINS & SOUTHSIDE OVERLAY (SEL. SECS.) (S)  
VARIOUS CITY STREETS  
INDEPENDENCE COUNTY



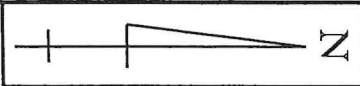

T 13 N

T 12 N

END SECTION 8  
LOG MILE 1.25

BEGIN SECTION 9  
(HWY. 167)  
LOG MILE 0.00

BEGIN SECTION 8  
(MC HUE RD.)  
LOG MILE 0.00

BEGIN SECTION 7  
(HWY. 167)  
LOG MILE 0.00

END SECTION 9  
LOG MILE 0.10

END SECTION 7  
(ALLEN CHAPEL RD.)  
LOG MILE 1.00

CITY OF  
SOUTHSIDE

BRUSHY RD

SOUTH FORK RD

SECTION LN



ENGLAND DR

TONY LN

REED RD

RICK RD

CEDAR CR

BRONCH

MCHUE RD

TROPHY LN

MOUNT VISTA CR

HEARTLEN LN

COMMUNITY DR

TRIPLE D LN

DOUBLE RD

BRANCH RD

TWIG

DOUBLE

BARRETT LN

JONES DR

ROBINSON LN

CRICK

PEPSI COLA RD

MUFFLER

RAYE

SHILOH LN

ZANES LN

HARMONY HOUSE LN

MCHUE RD

ALLEN CHAPEL RD

EDGER RD

SKY VIEW

R 6 W

JOB C32004  
PLEASANT PLAINS & SOUTHSIDE OVERLAY (SEL. SECS.) (S)  
VARIOUS CITY STREETS  
INDEPENDENCE COUNTY

ARK. HWY. DIST. NO. 5



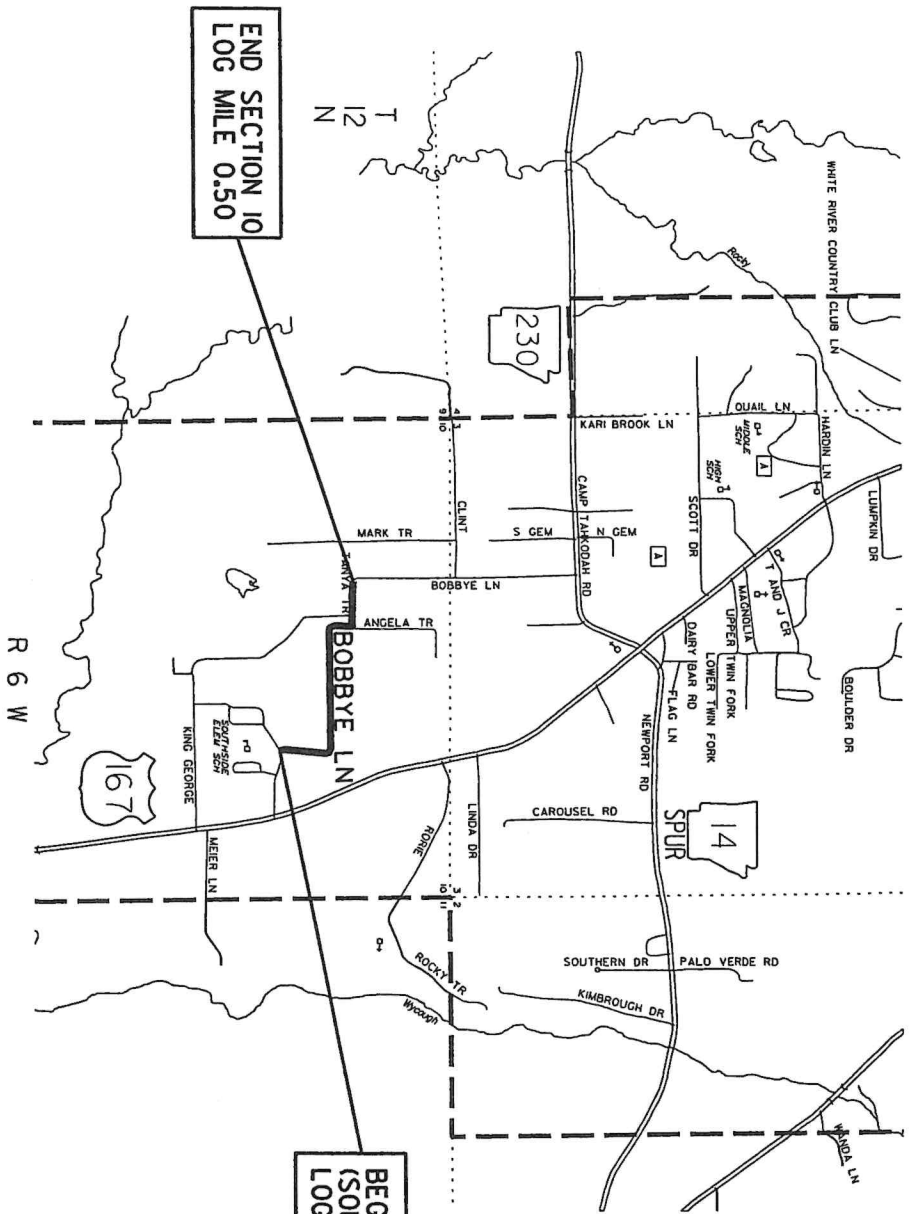
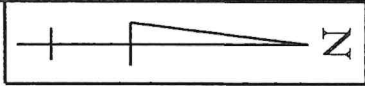

JOB C32004  
 PLEASANT PLAINS & SOUTHSIDE OVERLAY (SEL. SECS.) (S)  
 VARIOUS STREETS  
 INDEPENDENCE COUNTY



ARK. HWY. DIST. NO. 5



# INDEX OF SHEETS

SHEET NO.	TITLE	DRWG. NO.	DATE
1-4	TITLE SHEET		
5	INDEX OF SHEETS AND GOVERNING SPECIFICATIONS		
6-7	TYPICAL SECTIONS OF IMPROVEMENT		
8	SPECIAL DETAILS		
9-14	QUANTITIES		
15	SUMMARY OF QUANTITIES AND REVISIONS		
16	PAVEMENT MARKING DETAILS	PM-1	5-12-16
17	STANDARD TRAFFIC CONTROLS FOR HIGHWAY CONSTRUCTION	TC-1	9-02-15
18	STANDARD TRAFFIC CONTROLS FOR HIGHWAY CONSTRUCTION	TC-2	9-02-15
19	STANDARD TRAFFIC CONTROLS FOR HIGHWAY CONSTRUCTION	TC-3	9-02-15

## GOVERNING SPECIFICATIONS

THE FOLLOWING SUPPLEMENTAL SPECIFICATIONS AND SPECIAL PROVISIONS FOR THIS PROJECT SUPPLEMENT THE STANDARD SPECIFICATIONS, EDITION OF 2014. IN CASE OF CONFLICT, THE SUPPLEMENTAL SPECIFICATIONS AND SPECIAL PROVISIONS SHALL GOVERN.

NUMBER	TITLE
ERRATA	ERRATA FOR THE BOOK OF STANDARD SPECIFICATIONS
100-3	CONTRACTOR'S LICENSE
102-2	ISSUANCE OF PROPOSALS
108-1	LIQUIDATED DAMAGES
108-2	WORK ALLOWED PRIOR TO ISSUANCE OF WORK ORDER
400-1	TACK COATS
410-1	CONSTRUCTION REQUIREMENTS AND ACCEPTANCE OF ASPHALT CONCRETE PLANT MIX COURSES
604-1	RETROREFLECTIVE SHEETING FOR TRAFFIC CONTROL DEVICES IN CONSTRUCTION ZONES
JOB C32004	ADJUSTMENT OF QUANTITIES FOR STATE-AID STREET PROJECTS
JOB C32004	BIDDING REQUIREMENTS AND CONDITIONS
JOB C32004	BROADBAND INTERNET SERVICE FOR ASPHALT CONCRETE PLANT
JOB C32004	DENSITIES FOR ACHM SURFACE COURSE
JOB C32004	FLEXIBLE BEGINNING OF WORK
JOB C32004	MANDATORY ELECTRONIC CONTRACT
JOB C32004	RECYCLED ASPHALT SHINGLES
JOB C32004	SUBMISSION OF ASPHALT CONCRETE HOT MIX ACCEPTANCE RESULTS
JOB C32004	WARM MIX ASPHALT

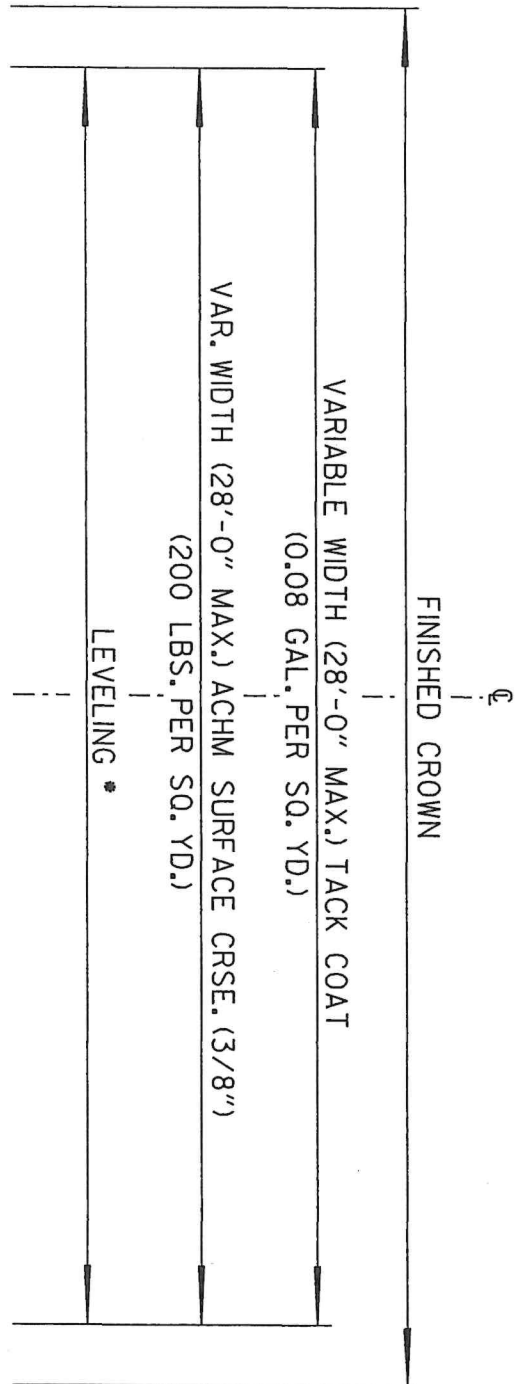

**TYPICAL SECTION OF IMPROVEMENT  
PLEASANT PLAINS**

NOTE: REPAIRS TO THE EXISTING SURFACE, SUPPLYING UTILITY RISERS, AND THE INSTALLATION OF PERMANENT SAFETY SIGNS NOT SHOWN ON PLANS ARE THE RESPONSIBILITIES OF THE CITY.

\*LOCATIONS AND APPLICATION RATES ARE AT THE DIRECTION OF THE ENGINEER. SEE QUANTITY SHEET FOR ESTIMATED AMOUNTS.

NOTE: PREPARATORY WORK SUCH AS CLIPPING THE GRASS AND DEBRIS FROM THE EDGE OF THE EXISTING ROADWAY WILL NOT BE PAID FOR DIRECTLY, BUT WILL BE CONSIDERED A PART OF THE OTHER ITEMS OF WORK, AFTER THE ROADWAY IS COMPLETED, THESE "CLIPPINGS" SHALL BE PULLED UP TO THE EDGE OF THE NEW PAVEMENT BY THE CONTRACTOR, NO DIRECT PAYMENT WILL BE MADE FOR THIS WORK.

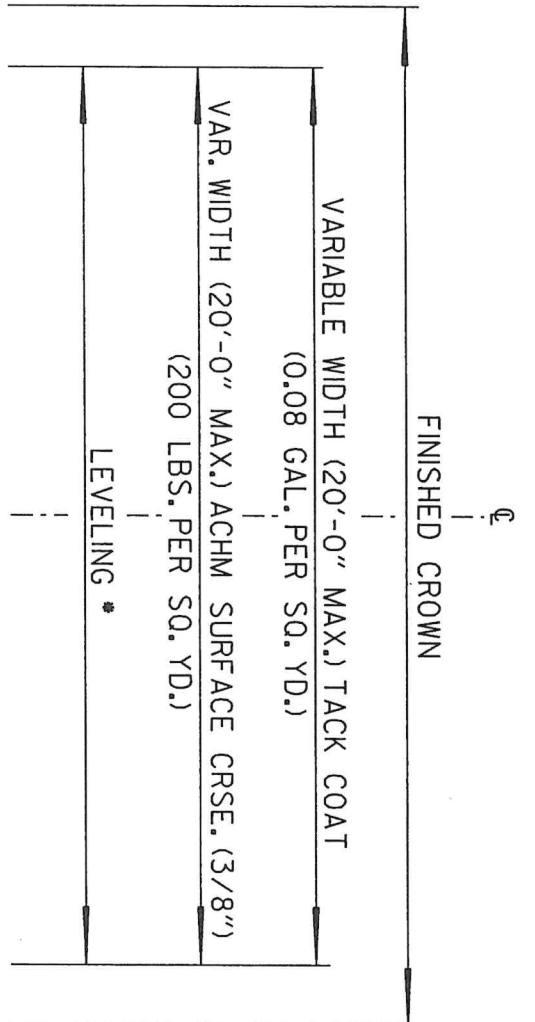

**TYPICAL SECTION OF IMPROVEMENT**  
**SOUTHSIDE**

NOTE: REPAIRS TO THE EXISTING SURFACE, SUPPLYING UTILITY RISERS, AND THE INSTALLATION OF PERMANENT SAFETY SIGNS NOT SHOWN ON PLANS ARE THE RESPONSIBILITIES OF THE CITY.

\*LOCATIONS AND APPLICATION RATES ARE AT THE DIRECTION OF THE ENGINEER. SEE QUANTITY SHEET FOR ESTIMATED AMOUNTS.

NOTE: PREPARATORY WORK SUCH AS CLIPPING THE GRASS AND DEBRIS FROM THE EDGE OF THE EXISTING ROADWAY WILL NOT BE PAID FOR DIRECTLY, BUT WILL BE CONSIDERED A PART OF THE OTHER ITEMS OF WORK. AFTER THE ROADWAY IS COMPLETED, THESE "CLIPPINGS" SHALL BE PULLED UP TO THE EDGE OF THE NEW PAVEMENT BY THE CONTRACTOR. NO DIRECT PAYMENT WILL BE MADE FOR THIS WORK.

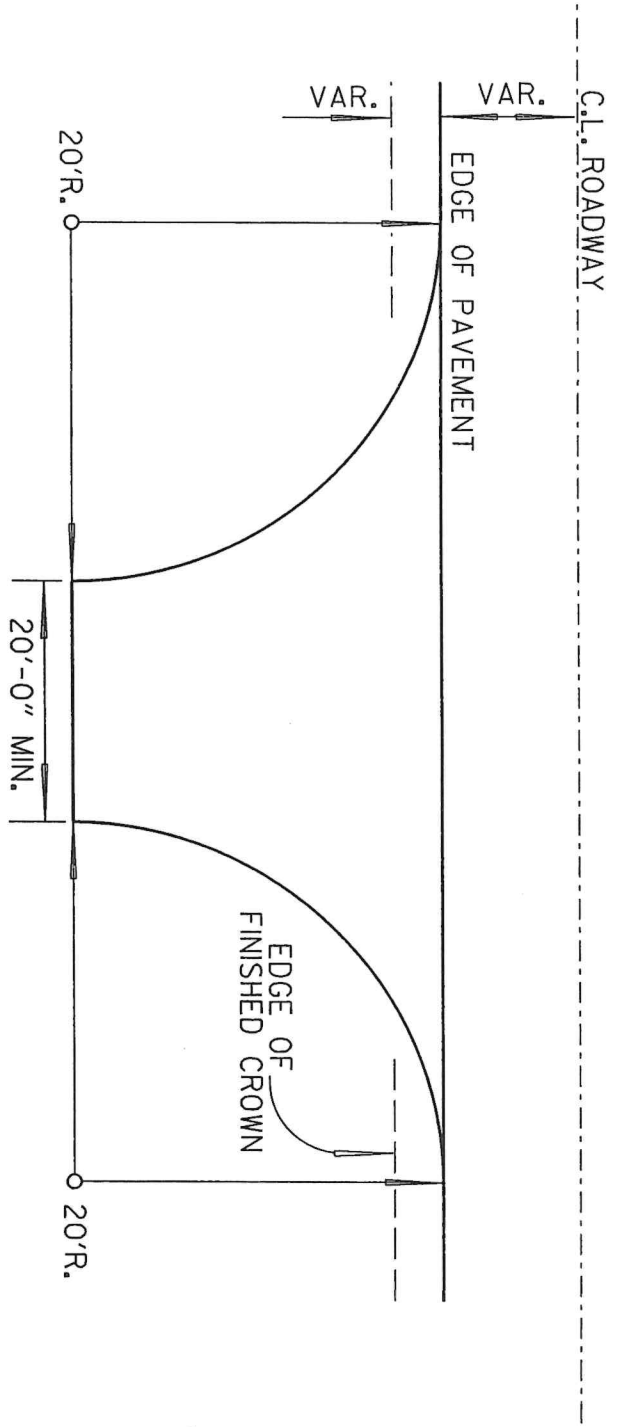

### TYPICAL TURNOUT 20' RADIUS

ADD'L. SURFACING AREA = 63.5 SQ. YDS.

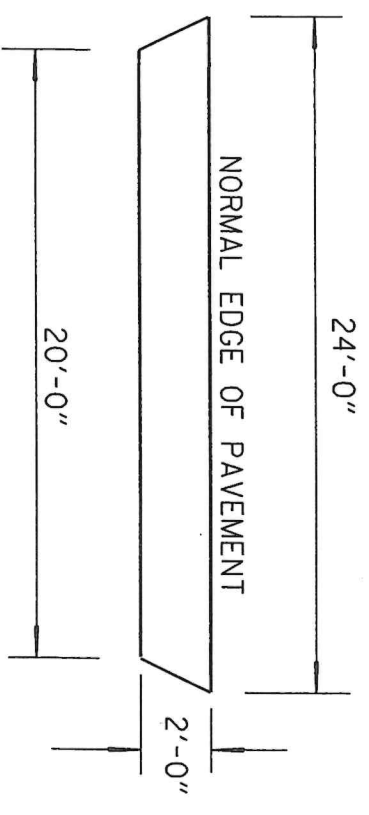

### TYPICAL PRIVATE ENTRANCES

ADD'L. SURFACING AREA = 4.9 SQ. YDS.



# SURFACING - PLEASANT PLAINS

LOCATION	LOG MILE		LENGTH LIN. FT.	WIDTH FEET	TACK COAT		ACHM SURFACE COURSE 3/8"		
	FROM	TO			SQ. YDS.	GALS.	SQ. YDS.	TONS	
<b>SECTION 1 - HAYES ST.</b>									
MAIN LANES	0.00	0.23	1214	20.0	2697.8	215.8	2697.8	269.8	
4 PRIVATE ENTRANCES					19.6	1.6	19.6	2.0	
LEVELING								25.0	
<b>SECTION 2 - BATESVILLE BLVD.</b>									
MAIN LANES	0.00	0.54	2851	28.0	8869.8	709.6	8869.8	887.0	
26 PRIVATE ENTRANCES					127.4	10.2	127.4	12.7	
2 CITY STREET TURNOUTS					127.0	10.2	127.0	12.7	
LEVELING								90.0	
<b>SECTION 3 - PEACEFUL DR.</b>									
MAIN LANES	0.00	0.41	2165	20.0	4811.1	384.9	4811.1	481.1	
14 PRIVATE ENTRANCES					68.6	5.5	68.6	6.9	
LEVELING								60.0	
<b>SECTION 4 - E. WOOD ST.</b>									
MAIN LANES	0.00	0.25	1320	20.0	2933.3	234.7	2933.3	293.3	
12 PRIVATE ENTRANCES					58.8	4.7	58.8	5.9	
1 CITY STREET TURNOUT					63.5	5.1	63.5	6.4	
LEVELING								30.0	
<b>SECTION 5 - WISH ST. (L.M. 0.00 - 0.06)</b>									
MAIN LANES	0.00	0.06	317	19.0	669.2	53.5	669.2	66.9	
LEVELING								10.0	
<b>SECTION 6 - WISH ST. (L.M. 0.06 - 0.80)</b>									
MAIN LANES	0.06	0.80	3907	20.0	8682.2	694.6	8682.2	868.2	
30 PRIVATE ENTRANCES					147.0	11.8	147.0	14.7	
3 CITY STREET TURNOUTS					190.5	15.2	190.5	19.1	
LEVELING								85.0	
TOTALS - PLEASANT PLAINS:								2357.4	3246.7
USE:								2357	3247

**BASIS OF ESTIMATE:**

TACK COAT \_\_\_\_\_ 0.08 GAL. PER SQ. YD.  
 ACHM SURFACE COURSE (3/8") \_\_\_\_\_ 200 LBS. PER SQ. YD.  
 Nmax=115

**PROPORTION BY WEIGHT ACHM SURF. CRSE. 1/2"**

MINERAL AGGREGATE \_\_\_\_\_ 94.6%  
 ASPHALT BINDER(PG 64-22) \_\_\_\_\_ 5.4%

## SURFACING - SOUTHSIDE

LOCATION	LOG MILE		LENGTH LIN. FT.	WIDTH FEET	TACK COAT		ACHM SURFACE COURSE 3/8"	
	FROM	TO			SQ. YDS.	GALS.	SQ. YDS.	TONS
<b>SECTION 7 - SOUTH FORK RD.</b>								
MAIN LANES	0.00	1.00	5280	18.0	10560.0	844.8	10560.0	1056.0
17 PRIVATE ENTRANCES					83.3	6.7	83.3	8.3
LEVELING								160.0
<b>SECTION 8 - BRUSHY RD.</b>								
MAIN LANES	0.00	1.25	6600	20.0	14666.7	1173.3	14666.7	1466.7
45 PRIVATE ENTRANCES					220.5	17.6	220.5	22.1
9 CITY STREET TURNOUTS					571.5	45.7	571.5	57.2
LEVELING								220.0
<b>SECTION 9 - SECTION LN.</b>								
MAIN LANES	0.00	0.10	528	18.0	1056.0	84.5	1056.0	105.6
6 PRIVATE ENTRANCES					29.4	2.4	29.4	2.9
LEVELING								10.0
<b>SECTION 10 - BOBBYE LN.</b>								
MAIN LANES	0.00	0.50	2640	20.0	5866.7	469.3	5866.7	586.7
10 PRIVATE ENTRANCES					49.0	3.9	49.0	4.9
2 CITY STREET TURNOUTS					127.0	10.2	127.0	12.7
LEVELING								90.0
TOTALS - SOUTHSIDE:					2658.4	2658.4		3803.1
USE:					2658			3803

**BASIS OF ESTIMATE:**  
 TACK COAT \_\_\_\_\_ 0.08 GAL. PER SQ. YD.  
 ACHM SURFACE COURSE (3/8") \_\_\_\_\_ 200 LBS. PER SQ. YD.  
**Nmax=115**

**PROPORTION BY WEIGHT ACHM SURF. CRSE. 1/2"**  
 MINERAL AGGREGATE \_\_\_\_\_ 94.6%  
 ASPHALT BINDER(PG 64-22) \_\_\_\_\_ 5.4%

## TRAFFIC CONTROL DEVICES - PLEASANT PLAINS

LOCATION	G20-1		G20-2	
	NO.	SQ. FT.	NO.	SQ. FT.
<b>SECTION 1 - HAYES ST.</b>				
END SECTION	1	10.00	1	8.00
<b>SECTION 2 - BATESVILLE BLVD.</b>				
BEGIN SECTION	1	10.00	1	8.00
END SECTION	1	10.00	1	8.00
<b>SECTION 3 - PEACEFUL DR.</b>				
BEGIN SECTION	1	10.00	1	8.00
<b>SECTION 4 - E. WOOD ST.</b>				
BEGIN SECTION	1	10.00	1	8.00
END SECTION	1	10.00	1	8.00
<b>SECTION 5 - WISH ST. (L.M. 0.00 - 0.06)</b>				
BEGIN SECTION	1	10.00	1	8.00
<b>SECTION 6 - WISH ST. (L.M. 0.06 - 0.80)</b>				
END SECTION	1	10.00	1	8.00
<b>TOTALS - PLEASANT PLAINS:</b>				
	8	80.00	8	64.00

# TRAFFIC CONTROL DEVICES - SOUTHSIDE

LOCATION	G20-1		G20-2	
	NO.	SQ. FT.	NO.	SQ. FT.
<b>SECTION 7 - SOUTHFORK RD.</b>				
BEGIN SECTION	1	10.00	1	8.00
END SECTION	1	10.00	1	8.00
<b>SECTION 8 - BRUSHY RD.</b>				
BEGIN SECTION	1	10.00	1	8.00
END SECTION	1	10.00	1	8.00
<b>SECTION 9 - SECTION LN.</b>				
BEGIN SECTION	1	10.00	1	8.00
END SECTION	1	10.00	1	8.00
<b>SECTION 10 - BOBBYE LN.</b>				
BEGIN SECTION	1	10.00	1	8.00
END SECTION	1	10.00	1	8.00
<b>TOTALS - SOUTHSIDE:</b>				
	8	80.00	8	64.00

## REFLECTORIZED PAINT PAVEMENT MARKING - PLEASANT PLAINS

LOCATION	WHITE MARKINGS	YELLOW MARKINGS
	4" EDGE LINE	4" CONTINUOUS
LINEAR FEET		
<b>SECTION 2 - BATESVILLE BLVD.</b>		
ENTIRE SECTION	5702	5702
<b>SECTION 5 - WISH ST. (L.M. 0.00 - 0.06)</b>		
ENTIRE SECTION		634
<b>SECTION 6 - WISH ST. (L.M. 0.06 - 0.80)</b>		
ENTIRE SECTION		7814
<b>TOTALS - PLEASANT PLAINS:</b>	5702	14150

NOTE: THIS IS A LOW VOLUME ROAD AS DEFINED IN SECTION 604.03  
OF THE STANDARD SPECIFICATIONS FOR HIGHWAY  
CONSTRUCTION, EDITION 2014.

## REFLECTORIZED PAINT PAVEMENT MARKING - SOUTHSIDE

LOCATION	LINEAR FEET	
	WHITE MARKINGS	YELLOW MARKINGS
<b>SECTION 8 - BRUSHY RD.</b>		
ENTIRE SECTION	13200	13200
<b>SECTION 10 - BOBBYE LN.</b>		
ENTIRE SECTION	5280	5280
<b>TOTALS - SOUTHSIDE:</b>	<b>18480</b>	<b>18480</b>

NOTE: THIS IS A LOW VOLUME ROAD AS DEFINED IN SECTION 604.03  
OF THE STANDARD SPECIFICATIONS FOR HIGHWAY  
CONSTRUCTION, EDITION 2014.

## SUMMARY OF QUANTITIES

ITEM NUMBER	I T E M	QUANTITY			UNIT
		CITY OF PLEASANT PLAINS	CITY OF SOUTHSIDE	JOB TOTALS	
SS & 401	TACK COAT	2357	2658	5015	GAL.
SP, SS, & 407	MINERAL AGGREGATE IN ACHM SURFACE COURSE (3/8")	3072	3598	6670	TON
SP, SS, & 407	ASPHALT BINDER (PG 64-22) IN ACHM SURFACE COURSE (3/8")	175	205	380	TON
601	MOBILIZATION	0.50	0.50	1.00	LUMP SUM
603	MAINTENANCE OF TRAFFIC	0.50	0.50	1.00	LUMP SUM
SS & 604	SIGNS	144	144	288	SQ. FT.
718	REFLECTORIZED PAINT PAVEMENT MARKING WHITE (4")	5702	18480	24182	LIN. FT.
718	REFLECTORIZED PAINT PAVEMENT MARKING YELLOW (4")	14150	18480	32630	LIN. FT.

### REVISIONS

DATE	REVISION	SHEET NO.

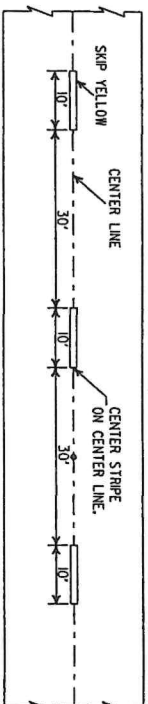
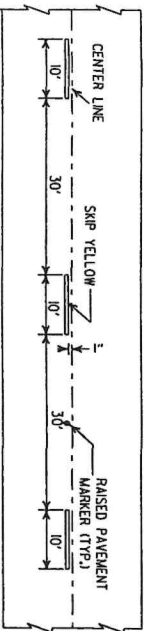

CONCRETE PAVEMENT

ASPHALT PAVEMENT

BROKEN LINE STRIPING

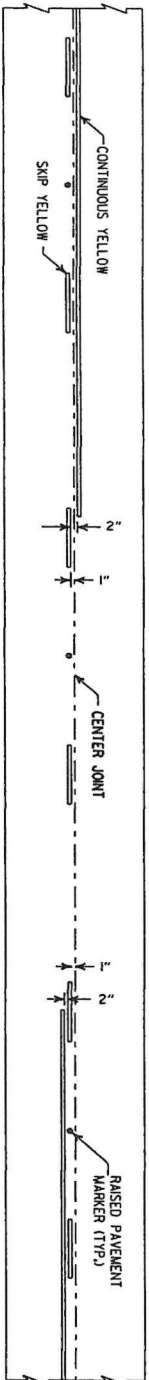

SOLID LINE STRIPING ON CONCRETE PAVEMENT

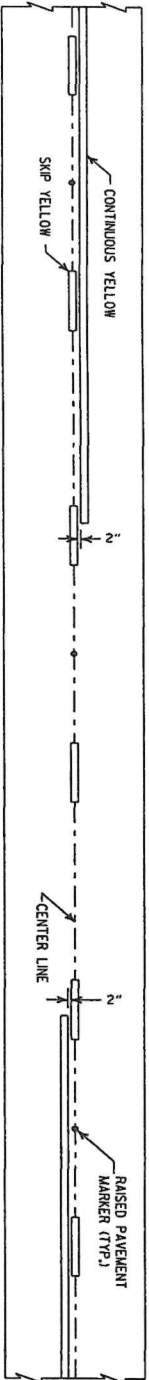

SOLID LINE STRIPING ON ASPHALT PAVEMENT

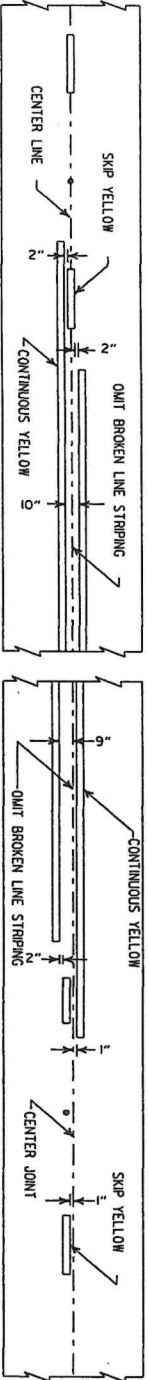

ASPHALT PAVEMENT

CONCRETE PAVEMENT

STRIPING AT ADJACENT NO PASSING LANES

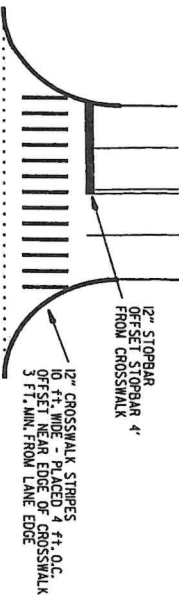

CROSSWALK AND STOPBAR DETAILS

- NOTES:
1. REFER TO THE STRIPING DETAILS FOR PAVEMENT MARKING LINE WIDTHS.
  2. THIS DRAWING SHALL BE USED IN CONJUNCTION WITH THE LATEST REVISED ADDITION OF THE "MANUAL ON UNIFORM TRAFFIC CONTROL DEVICES."
  3. RAISED PAVEMENT MARKERS SHALL BE PLACED ON AN 80 FEET SPACING UNLESS OTHERWISE SHOWN IN THE PLANS.

2" FOR ASPHALT OR CONCRETE PAVEMENT  
6" FOR BITUMINOUS SURFACE TREATMENT

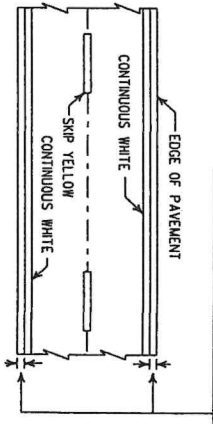

PAVEMENT EDGE LINE MARKING

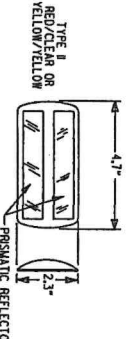

DETAIL OF STANDARD RAISED PAVEMENT MARKERS

NOTE:  
DIMENSIONS SHOWN FOR RAISED PAVEMENT MARKERS ARE TYPICAL. THE CONTRACTOR MAY SUBSTITUTE SIMILAR MARKERS WITH THE APPROVAL OF THE ENGINEER, REQUESTING APPROVAL FOR SIMILAR MARKERS MAY BE MADE BY REFERRING TO THE AHD QUALIFIED PRODUCTS LIST.

NOTE:  
THE RED LENS OF THE TYPE A R.P.M. SHALL FACE THE INCORRECT TRAFFIC MOVEMENT.

DATE	REVISION	BY	CHKD	APP'D
5-12-16	REVISED LINE WIDTHS, SPACING, & NOTES			
9-12-13	REVISED DETAIL OF STANDARD RAISED PAVEMENT MARKERS			
11-17-10	REVISED GENERAL NOTES & REMOVED FLOABLE PAINT MARKS			
11-18-04	REVISED NOTE 2 & GENERAL NOTES			
8-22-02	ADDED CROSSWALK & STOPBAR DETAILS			
7-02-98	ADDED DETAILS OF STD. RAISED PAVEMENT MARKERS			
4-26-96	REV. NOTES 3&4; ADDED R.P.M.			
9-30-80	ORIGIN			

PAVEMENT MARKING DETAILS

STANDARD DRAWING PM-1

ARKANSAS STATE HIGHWAY COMMISSION





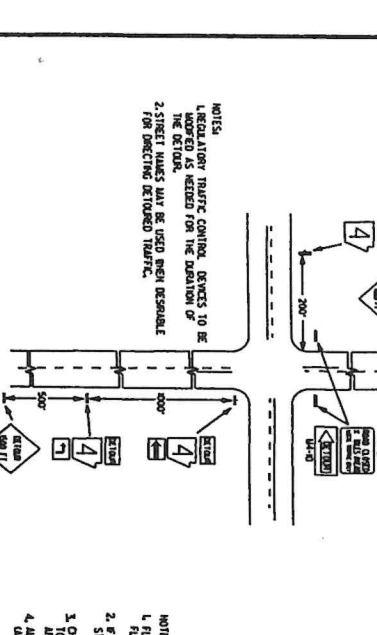

(A) TYPICAL APPLICATION OF TRAFFIC CONTROL DEVICES ON A 2-LANE ROADWAY WHERE THE ENTIRE ROADWAY IS CLOSED AND A BYPASS DETOUR IS PROVIDED.

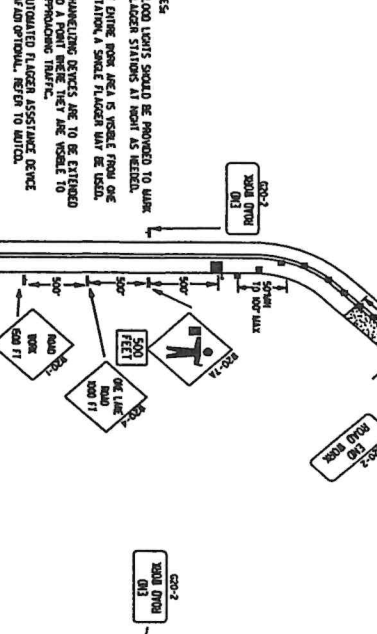

(B) TYPICAL APPLICATION OF TRAFFIC CONTROL DEVICES ON A 4-LANE UNDIVIDED ROADWAY WHERE ONE ROADWAY IS CLOSED.

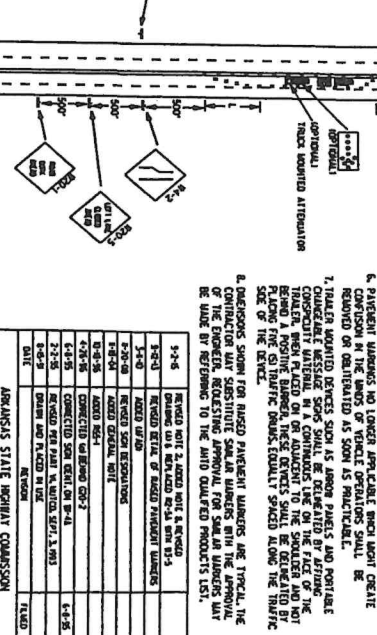

(C) TYPICAL APPLICATION OF TRAFFIC CONTROL DEVICES ON A 4-LANE UNDIVIDED ROADWAY WITH RIGHT LANE CLOSED.

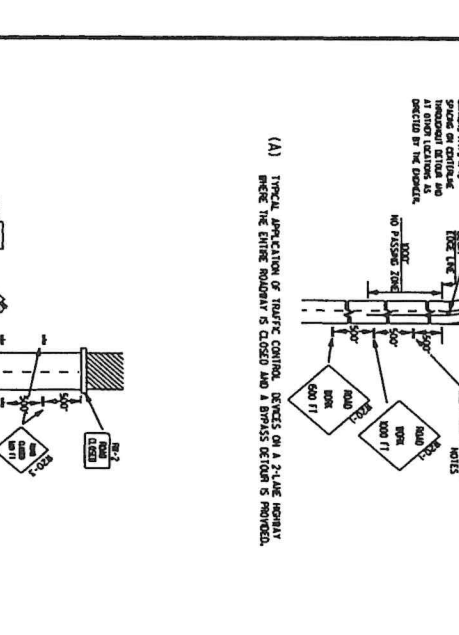

(D) TYPICAL APPLICATION OF TRAFFIC CONTROL DEVICES ON A 2-LANE ROADWAY WITH A NARROW LANE CLOSURE.

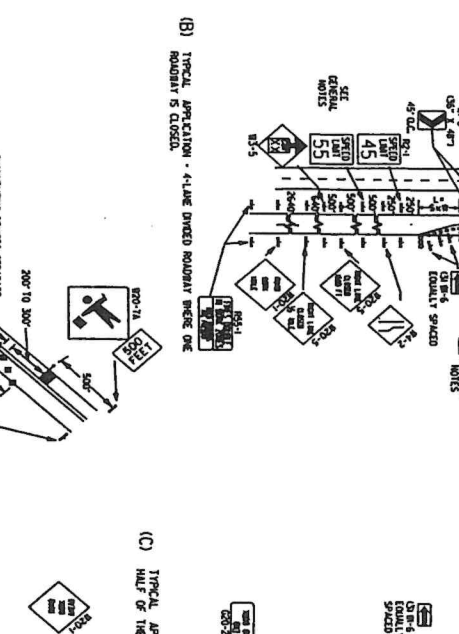

(E) TYPICAL APPLICATION OF TRAFFIC CONTROL DEVICES ON A 4-LANE UNDIVIDED ROADWAY WITH RIGHT LANE CLOSED.

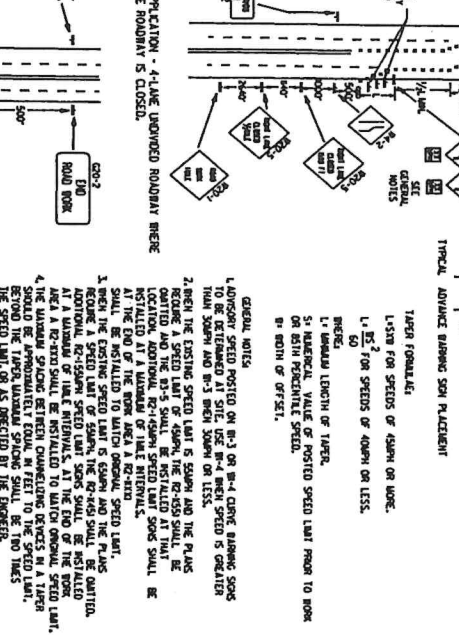

(F) TYPICAL APPLICATION OF TRAFFIC CONTROL DEVICES ON A 4-LANE UNDIVIDED ROADWAY WITH RIGHT LANE CLOSED.



(G) TYPICAL APPLICATION OF TRAFFIC CONTROL DEVICES ON A 4-LANE UNDIVIDED ROADWAY WITH RIGHT LANE CLOSED.

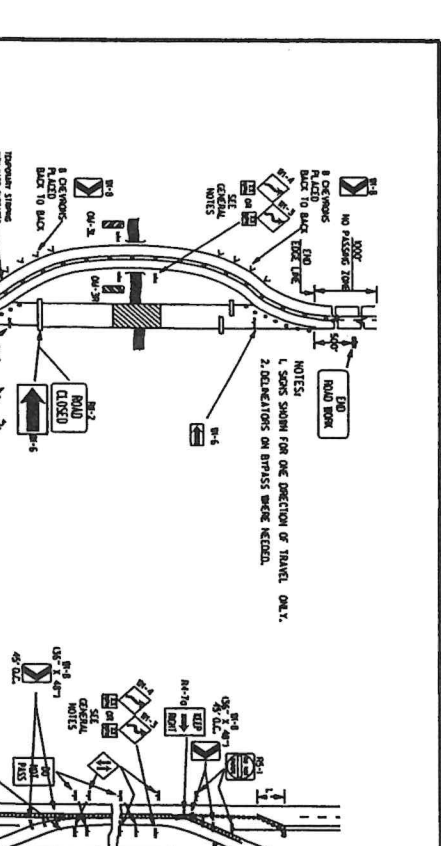

(H) TYPICAL APPLICATION OF TRAFFIC CONTROL DEVICES ON A 4-LANE UNDIVIDED ROADWAY WITH RIGHT LANE CLOSED.

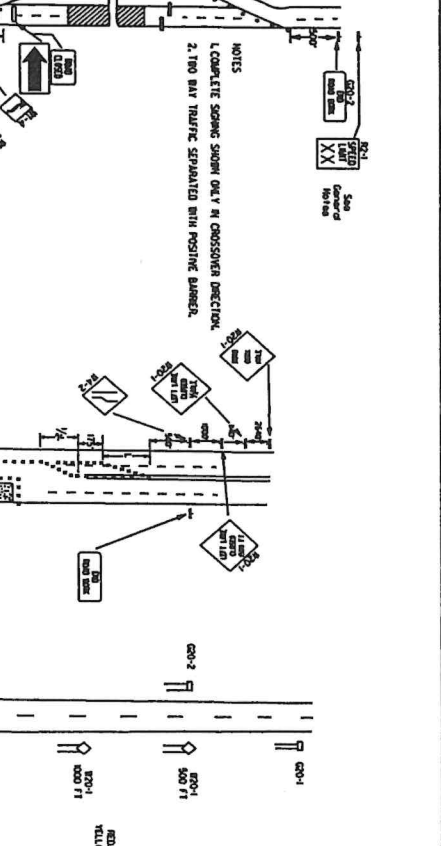

(I) TYPICAL APPLICATION OF TRAFFIC CONTROL DEVICES ON A 4-LANE UNDIVIDED ROADWAY WITH RIGHT LANE CLOSED.

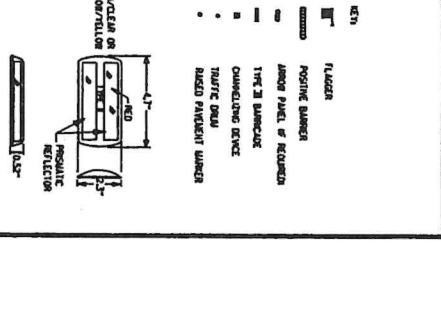

(J) TYPICAL APPLICATION OF TRAFFIC CONTROL DEVICES ON A 4-LANE UNDIVIDED ROADWAY WITH RIGHT LANE CLOSED.

GENERAL NOTES:  
 1. ADVANCE SPEED POSTING ON R-1 OR R-2 SHOULD BE PLACED TO BE DETOURED AT THE SITE. USE R-4 WHEN SPEED IS GREATER THAN 50 MPH AND R-3 WHEN SPEED IS LESS.  
 2. WHEN THE EXISTING SPEED LIMIT IS 55 MPH AND THE PLANS REQUIRE A SPEED LIMIT OF 45 MPH, THE R-255S SHALL BE INSTALLED AND THE R-3 SHALL BE INSTALLED AT HALF THE SPACING AND AT A MAXIMUM OF 100 FEET INTERVALS.  
 3. THE SPEED LIMIT, OR AS DIRECTED BY THE ENGINEER, SHALL BE INSTALLED TO MATCH THE EXISTING SPEED LIMIT.  
 4. THE NUMBER OF SPEED LIMIT SIGNS SHALL BE LIMITED TO ONE AT A MAXIMUM OF 100 FEET INTERVALS.  
 5. THE NUMBER OF SPEED LIMIT SIGNS SHALL BE LIMITED TO ONE AT THE END OF THE WORK AREA A REVERSE SPEED LIMIT.  
 6. THE NUMBER OF SPEED LIMIT SIGNS SHALL BE LIMITED TO ONE AT THE END OF THE WORK AREA A REVERSE SPEED LIMIT.  
 7. TRAFFIC CONTROL DEVICES SUCH AS ARROW PLATES AND PORTABLE CONSPICUOUS MATERIAL IN A CONTINUOUS LINE ON THE FACE OF THE ROADWAY SHALL BE PLACED TO THE SPALLER AND NOT PLACED TO THE CURB OR SIDEWALK. THESE DEVICES SHALL BE PLACED TO THE SPALLER AND NOT PLACED TO THE CURB OR SIDEWALK.  
 8. DIMENSIONS SHOWN FOR RATED PASSIVE WARNERS ARE TYPICAL. THE CONTRACTOR MAY SUBSTITUTE EQUAL WARNERS WITH THE APPROVAL OF THE ENGINEER. REQUESTING APPROVAL FOR EQUAL WARNERS MAY BE MADE BY REFERENCING TO THE AASHTO QUALIFIED PRODUCTS LIST.  
 9. DIMENSIONS SHOWN FOR RATED PASSIVE WARNERS ARE TYPICAL. THE CONTRACTOR MAY SUBSTITUTE EQUAL WARNERS WITH THE APPROVAL OF THE ENGINEER. REQUESTING APPROVAL FOR EQUAL WARNERS MAY BE MADE BY REFERENCING TO THE AASHTO QUALIFIED PRODUCTS LIST.

NOTES:  
 1. REGULATORY TRAFFIC CONTROL DEVICES TO BE PLACED SHALL BE PLACED FOR THE LOCATION OF THE DETOUR.  
 2. STREET MARKS MAY BE USED WHEN DESIRABLE FOR DIRECTING DETOURED TRAFFIC.

NOTES:  
 1. FLOOD LIGHTS SHOULD BE PROVIDED TO MARK FLAGGER STATIONS AT NIGHT AS WENDED.  
 2. IF EXISTING ROAD AREA IS VISIBLE FROM ONE STATION, A SINGLE FLAGGER MAY BE USED.  
 3. COMMUNING DEVICES ARE TO BE EXTENDED TO MAKE THE ROADWAY AS VISIBLE TO APPROXIMATE TRAFFIC AS THE VEHICLE TO BE DETOURED.  
 4. AUTOMATED FLAGGER ASSISTANT DEVICES ARE AN OPTION. REFER TO MANUAL.

NOTES:  
 1. COMPLETE STOPPING SHOULD BE ON CROSSOVER DETOUR.  
 2. TWO BAY TRAFFIC SEPARATED WITH POSITIVE BARRIER.

NOTES:  
 1. COMPLETE STOPPING SHOULD BE ON CROSSOVER DETOUR.  
 2. TWO BAY TRAFFIC SEPARATED WITH POSITIVE BARRIER.

NOTES:  
 1. COMPLETE STOPPING SHOULD BE ON CROSSOVER DETOUR.  
 2. TWO BAY TRAFFIC SEPARATED WITH POSITIVE BARRIER.

NOTES:  
 1. COMPLETE STOPPING SHOULD BE ON CROSSOVER DETOUR.  
 2. TWO BAY TRAFFIC SEPARATED WITH POSITIVE BARRIER.

NOTES:  
 1. COMPLETE STOPPING SHOULD BE ON CROSSOVER DETOUR.  
 2. TWO BAY TRAFFIC SEPARATED WITH POSITIVE BARRIER.

NOTES:  
 1. COMPLETE STOPPING SHOULD BE ON CROSSOVER DETOUR.  
 2. TWO BAY TRAFFIC SEPARATED WITH POSITIVE BARRIER.

NOTES:  
 1. COMPLETE STOPPING SHOULD BE ON CROSSOVER DETOUR.  
 2. TWO BAY TRAFFIC SEPARATED WITH POSITIVE BARRIER.

NOTES:  
 1. COMPLETE STOPPING SHOULD BE ON CROSSOVER DETOUR.  
 2. TWO BAY TRAFFIC SEPARATED WITH POSITIVE BARRIER.

ITEM	QUANTITY	DESCRIPTION
1-4	1	REGULATORY TRAFFIC CONTROL DEVICES TO BE PLACED FOR THE LOCATION OF THE DETOUR.
2-4	1	STREET MARKS MAY BE USED WHEN DESIRABLE FOR DIRECTING DETOURED TRAFFIC.
3-4	1	FLOOD LIGHTS SHOULD BE PROVIDED TO MARK FLAGGER STATIONS AT NIGHT AS WENDED.
4-4	1	IF EXISTING ROAD AREA IS VISIBLE FROM ONE STATION, A SINGLE FLAGGER MAY BE USED.
5-4	1	COMMUNING DEVICES ARE TO BE EXTENDED TO MAKE THE ROADWAY AS VISIBLE TO APPROXIMATE TRAFFIC AS THE VEHICLE TO BE DETOURED.
6-4	1	AUTOMATED FLAGGER ASSISTANT DEVICES ARE AN OPTION. REFER TO MANUAL.
7-4	1	COMPLETE STOPPING SHOULD BE ON CROSSOVER DETOUR.
8-4	1	TWO BAY TRAFFIC SEPARATED WITH POSITIVE BARRIER.

ARKANSAS STATE HIGHWAY COMMISSION  
 STANDARD TRAFFIC CONTROL  
 FOR HIGHWAY CONSTRUCTION  
 STANDARD DRAWING TC-2

Chromizing devices



\* When cones are used on freeways, grade-separated ramps, or other areas where cones and barrels are used on of roadway, and shall be placed in accordance with the MUTCD.

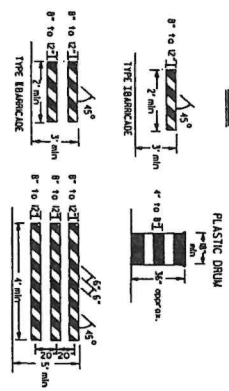

NOTE: For all road closures the Type B barricades shall be placed in a line with the length to extend across entire roadway.

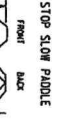
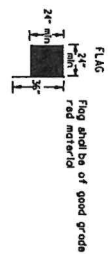

VERTICAL PANEL PLACEMENT

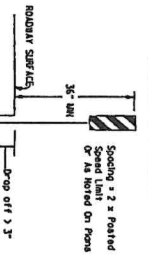

DETAIL OF SPACES 3' OR MORE

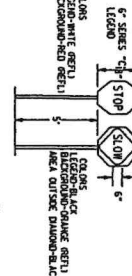

NOTE: USE SPACES ONLY WHEN NECESSARY. SPACES SHALL BE 36" MIN. SPACING. SPACES SHALL BE 36" MIN. SPACING. SPACES SHALL BE 36" MIN. SPACING. SPACES SHALL BE 36" MIN. SPACING.

TRAFFIC CONTROL DEVICES FOR DIFFERENTIALS

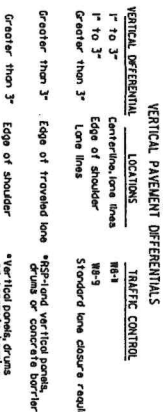

When shown on the plans, concrete barrier shall be used. When the shoulder area is used on parts of the traveled lane and there is insufficient width to place drums on the remaining shoulder width, then vertical panels shall be used.

(A) Typical application - daytime maintenance operations of short duration on a 4-lane divided roadway where half of the roadway is closed.

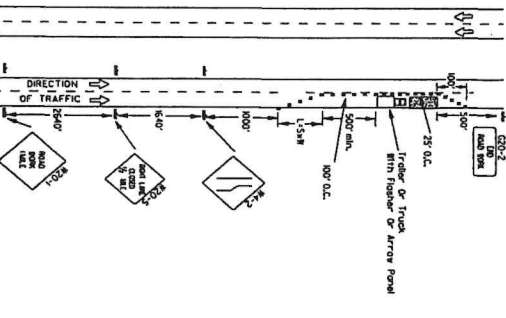

(B) Typical application - 3-lane roadway where center lane is closed.

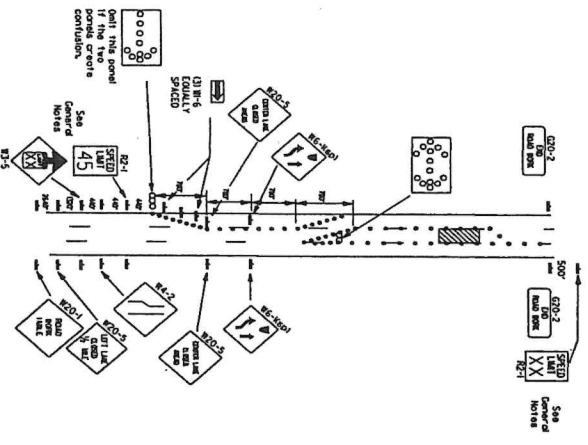

GENERAL NOTES:

1. A speed limit reduction may be implemented ONLY when authorized in the plan or when recommended by the Roadway Design Division.
2. When the existing speed limit is 55mph and the plans require a speed limit of 45mph, the R2-45S shall be carried and the R3-5 shall be installed at that location. Additional R2-45S speed limit signs shall be installed at a minimum of 1000' in advance of the work area or 1000' in advance of the existing speed limit.
3. When the existing speed limit is 55mph and the plans require a speed limit of 45mph, the R2-45S shall be carried. Additional R2-45S signs shall be installed at the work area or a R2-45S shall be installed to match original speed limit.
4. The minimum spacing between depending devices in a tower should be according to spacing listed to the speed limit. Beyond the tower, minimum spacing shall be two times the speed limit or as directed by the Engineer.
5. Warning lights and/or flags may be mounted to signs or chromizing devices at night as needed.
6. Permanent markings no longer applicable which might create confusion in the minds of vehicle operators shall be removed or obliterated as soon as practicable.
7. The CD-1 sign shall be carried on jobs of over two miles in length. The CD-1 sign shall be placed in advance of the project. Additional CD-1 signs are not required in advance of the work area that begin inside the project limits.
8. Rogers and/or S1P/S1O paddles for controlling traffic through work zones, flags may be used only for emergency situations.
9. All traffic signs and cones shall be the requirements of NCHRP-350 or Manual on Uniform Traffic Control Devices (MUTCD).
10. Traffic mounted devices such as error posts and portable changeable message signs shall be placed in advance of the work area or adjacent to the shoulder and not behind a passive barrier, these devices shall be demarcated by placing five (5) traffic drums, evenly spaced along the traffic side of the device.

(C) Typical application - construction operations of intermediate to long term duration on a 4-lane divided roadway where half of the roadway is closed.

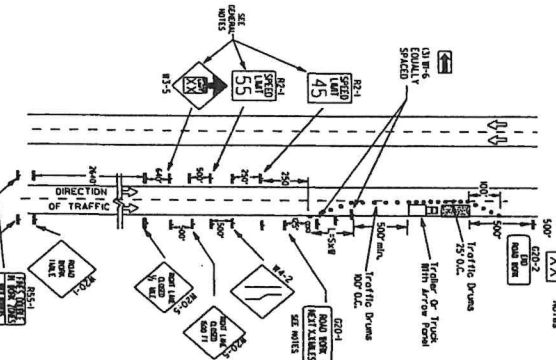

(D) Typical application - closing multiple lanes of a multi-lane highway.

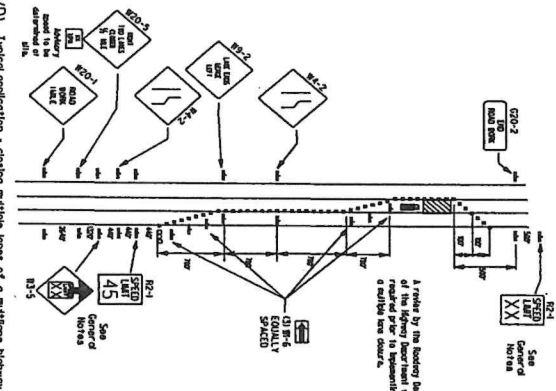

DATE	REVISION	BY	CHKD
0-0-00	REVISION 2 & 3 REVISED 0-2-01 WITH B1-5		
1-20-01	REVISION 4 TO 6		
0-0-00	REVISION 5		
0-0-00	REVISION 6		
0-0-00	REVISION 7		
0-0-00	REVISION 8		
0-0-00	REVISION 9		
0-0-00	REVISION 10		
0-0-00	REVISION 11		
0-0-00	REVISION 12		
0-0-00	REVISION 13		
0-0-00	REVISION 14		
0-0-00	REVISION 15		
0-0-00	REVISION 16		
0-0-00	REVISION 17		
0-0-00	REVISION 18		
0-0-00	REVISION 19		
0-0-00	REVISION 20		
0-0-00	REVISION 21		
0-0-00	REVISION 22		
0-0-00	REVISION 23		
0-0-00	REVISION 24		
0-0-00	REVISION 25		
0-0-00	REVISION 26		
0-0-00	REVISION 27		
0-0-00	REVISION 28		
0-0-00	REVISION 29		
0-0-00	REVISION 30		
0-0-00	REVISION 31		
0-0-00	REVISION 32		
0-0-00	REVISION 33		
0-0-00	REVISION 34		
0-0-00	REVISION 35		
0-0-00	REVISION 36		
0-0-00	REVISION 37		
0-0-00	REVISION 38		
0-0-00	REVISION 39		
0-0-00	REVISION 40		
0-0-00	REVISION 41		
0-0-00	REVISION 42		
0-0-00	REVISION 43		
0-0-00	REVISION 44		
0-0-00	REVISION 45		
0-0-00	REVISION 46		
0-0-00	REVISION 47		
0-0-00	REVISION 48		
0-0-00	REVISION 49		
0-0-00	REVISION 50		

ARKANSAS STATE HIGHWAY COMMISSION  
STANDARD TRAFFIC CONTROL S  
FOR HIGHWAY CONSTRUCTION  
STANDARD DRAWING 1C-3